

## DIN Rails, Flat Design

The DIN Rails are designed in accordance with the European Standard EN 60715 using state of the art production processes to ensure high dimensional accuracy, restricted tolerances and outstanding surface tempering. The Din Rails are available in standard lengths of 1M and 2M with or without mounting slots on request. We also provide Profile Cutters for individual processing.

The TDR2 series has 2<sup>nd</sup> generation passivations of Cr<sup>3+</sup>, light iridescence colour, higher thickness film 200nm~400nm and improved corrosion resistance as compared to the 1<sup>st</sup> generation passivations. Our entire range of DIN rails are RoHS Compliant.



**DIN Rails  
TDR2 15/5,5**

**DIN Rails  
TDR2 35/7,5**

| Description   | Type                         | Article No. |   | Type                         | Article No. |   |
|---|------------------------------|-------------|---|------------------------------|-------------|---|
| <b>DIN Rail ,Unperforated</b><br>In acc. With EN 60715-15X5,5, chromated,length:2M                              | TDR2-15/5,5 Unperforated /2M | 1 17 00252  | 1 |                              |             |   |
| <b>DIN Rail ,Unperforated</b><br>In acc. With EN 60715-15X5,5, chromated,length:1M                              | TDR2-15/5,5 Unperforated /1M | 1 17 00253  | 1 |                              |             |   |
| <b>DIN Rail ,Perforated</b><br>In acc. With EN 60715-15X5,5, Chromated,length:2M                                | TDR2-15/5,5 Perforated /2M   | 1 17 00254  | 1 |                              |             |   |
| <b>DIN Rail ,Perforated</b><br>In acc. With EN 60715-15X5,5, Chromated,length:1M                                | TDR2-15/5,5 Perforated /1M   | 1 17 00255  | 1 |                              |             |   |
| <b>DIN Rail ,Unperforated</b><br>In acc. With EN 60715-35x7,5, Flat Design, chromated, for universal cutting:2M |                              |             |   | TDR2-35/7,5 Unperforated /2M | 1 17 00256  | 1 |
| <b>DIN Rail ,Unperforated</b><br>In acc. With EN 60715-35x7,5, Flat Design, chromated, for universal cutting:1M |                              |             |   | TDR2-35/7,5 Unperforated /1M | 1 17 00270  | 1 |
| <b>DIN Rail ,perforated</b><br>In acc. With EN 60715-35x7,5, Flat Design, chromated, for universal cutting:2M   |                              |             |   | TDR2-35/7,5 Perforated /2M   | 1 17 00271  | 1 |
| <b>DIN Rail ,perforated</b><br>In acc. With EN 60715-35x7,5, Flat Design, chromated, for universal cutting:1M   |                              |             |   | TDR23-5/7,5 Perforated /1M   | 1 17 00272  | 1 |

**Base Metal:** Cold rolled low carbon steel according to DIN & European standard EN10130

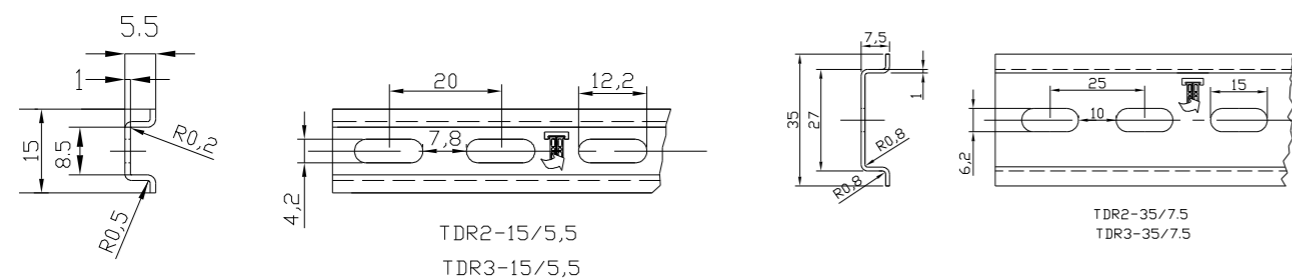

## DIN Rails, Flat Design

In accordance with IEC60947-7-2, DIN rails made of steel may be used as equipotential busbars (PE function), but without PEN function.



**DIN Rails  
TDR2 35/15**

| Description   | Type                         | Article No. |   |
|---|------------------------------|-------------|---|
| <b>DIN Rail Unperforated</b><br>In acc. With EN 60715-35x15, high design, chromated , for universal cutting length:2M | TDR2- 35/15 Unperforated /2M | 1 17 00273  | 1 |
| <b>DIN Rail Unperforated</b><br>In acc. With EN 60715-35x15, high design, chromated , for universal cutting length:1M | TDR2- 35/15 Unperforated /1M | 1 17 00274  | 1 |
| <b>DIN Rail perforated</b><br>In acc. With EN 60715-35x15, high design, chromated , for universal cutting length:2M   | TDR2- 35/15 Perforated /2M   | 1 17 00275  | 1 |
| <b>DIN Rail perforated</b><br>In acc. With EN 60715-35x15, high design, chromated , for universal cutting length:1M   | TDR2- 35/15 Perforated /1M   | 1 17 00276  | 1 |

**Base Metal:** Cold rolled low carbon steel according to DIN & European standard EN10130  
**Note:** Surface coating of TDR2 series Din Rail in accordance to EN 12329, Fe/Zn 8B. Blue Passivated RoHS confirm. 2-3 times better corrosion resistance than Conventional Hexavalent chromium, Color of coating bright blue

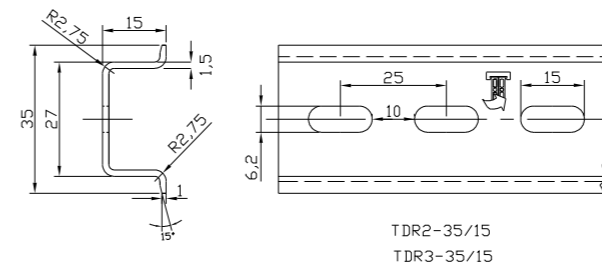

## DIN Rails, Flat Design

DIN Rails are available in various base metals of which the most common is steel .In addition the DIN rail is available in various finishes with respect to the base metal. The most common plating is that of zinc .Zinc being more noble than steel will sacrifice itself for the protection of the base metal against the elements of corrosion. Keeping in mind the demand of the industry we have introduced the TDR3 series of DIN rail having 3rd generation passivations of Cr<sup>3+</sup>. The TDR3 series has light iridescence colour, highest thickness film (300nm–400nm) improved corrosion resistance, is Fluoride free & Organic acid free and has low metal concentration



**DIN Rails  
TDR3- 15/5,5**



**DIN Rails  
TDR3- 35/7,5**

| Description   | Type                         | Article No. |   | Type                         | Article No. |   |
|---|------------------------------|-------------|---|------------------------------|-------------|---|
| <b>DIN Rail ,Unperforated</b><br>In acc. With EN 60715-15X5,5, chromated,length:2M                              | TDR3-15/5,5 Unperforated /2M | 1 17 00277  | 1 |                              |             |   |
| <b>DIN Rail ,Unperforated</b><br>In acc. With EN 60715-15X5,5, chromated,length:1M                              | TDR3-15/5,5 Unperforated /1M | 1 17 00278  | 1 |                              |             |   |
| <b>DIN Rail ,Perforated</b><br>In acc. With EN 60715-15X5,5, Chromated,length:2M                                | TDR3-15/5,5 Perforated /2M   | 1 17 00279  | 1 |                              |             |   |
| <b>DIN Rail ,Perforated</b><br>In acc. With EN 60715-15X5,5, Chromated,length:1M                                | TDR3-15/5,5 Perforated /1M   | 1 17 00280  | 1 |                              |             |   |
| <b>DIN Rail ,Unperforated</b><br>In acc. With EN 60715-35x7,5, Flat Design, chromated, for universal cutting:2M |                              |             |   | TDR3-35/7,5 Unperforated /2M | 1 17 00281  | 1 |
| <b>DIN Rail ,Unperforated</b><br>In acc. With EN 60715-35x7,5, Flat Design, chromated, for universal cutting:1M |                              |             |   | TDR3-35/7,5 Unperforated /1M | 1 17 00282  | 1 |
| <b>DIN Rail ,perforated</b><br>In acc. With EN 60715-35x7,5, Flat Design, chromated, for universal cutting:2M   |                              |             |   | TDR3-35/7,5 Perforated /2M   | 1 17 00283  | 1 |
| <b>DIN Rail ,perforated</b><br>In acc. With EN 60715-35x7,5, Flat Design, chromated, for universal cutting:1M   |                              |             |   | TDR3-35/7,5 Perforated /1M   | 1 17 00284  | 1 |

**Base Metal:** Cold rolled low carbon steel according to DIN & European standard En10130

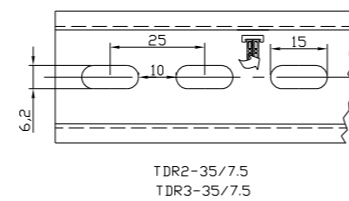
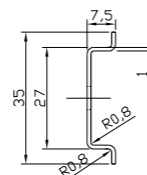
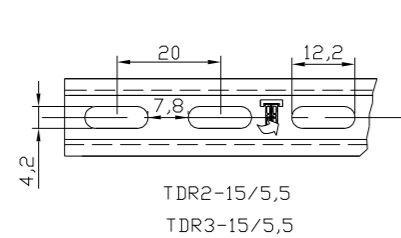
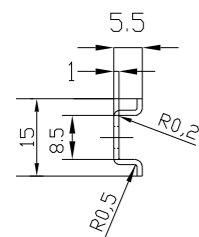

## DIN Rails, Flat Design

The use of DIN rail enables the manufacturers to specify the electrical components desired without concern for being committed to single supplier. In addition the use of DIN rail saves time and space



**DIN Rails  
TDR335/15**

| Description   | Type                         | Article No. |   |
|---|------------------------------|-------------|---|
| <b>DIN Rail Unperforated</b><br>In acc. With EN 60715-35x15, high design, chromated , for universal cutting length:2M | TDR3- 35/15 Unperforated /2M | 1 17 00285  | 1 |
| <b>DIN Rail Unperforated</b><br>In acc. With EN 60715-35x15, high design, chromated , for universal cutting length:1M | TDR3- 35/15 Unperforated /1M | 1 17 00286  | 1 |
| <b>DIN Rail perforated</b><br>In acc. With EN 60715-35x15, high design, chromated , for universal cutting length:2M   | TDR3- 35/15 Perforated /2M   | 1 17 00287  | 1 |
| <b>DIN Rail perforated</b><br>In acc. With EN 60715-35x15, high design, chromated , for universal cutting length:1M   | TDR3- 35/15 Perforated /1M   | 1 17 00288  | 1 |

**Base Metal:** Cold rolled low carbon steel according to DIN & European standard EN10130  
**Note:** Surface coating of TDR3 series Din Rail in accordance to EN 12329, Fe/Zn 8C, Light iridescence color, give blue/yellow/green iridescent. Appearance, RoHS confirm, Very high corrosion resistance, Neutral Salt spray withstands minimum 120 hrs. (White rust), organic Acid free, Fluoride free, Higher thermal resistance

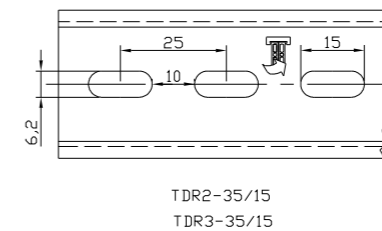
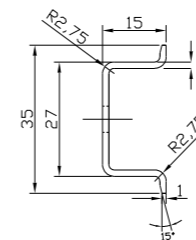

## Mounting Rails

The BG....brackets enable the DIN rails to be mounted with a spacing or at an angle of 30°.

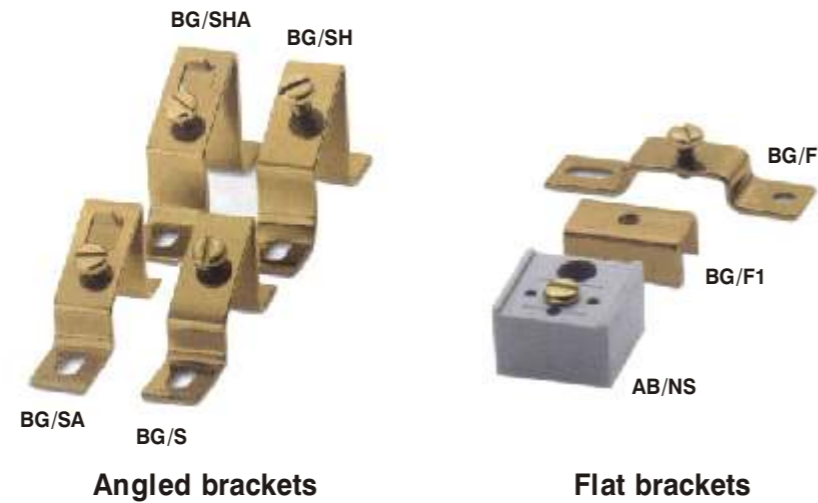

Angled brackets

Flat brackets

| Description   | Type             | Article No. |    | Type                            | Article No. |    |
|---|------------------|-------------|----|---------------------------------|-------------|----|
| <b>Angled bracket,</b><br>for fixing DIN rails at an angle of 30° with M6 screw,<br>height: 35.4 mm   | BG/S             | 1 17 00261  | 10 |                                 |             |    |
| <b>Angled bracket,</b><br>as above, however, with stop for the DIN rail   | BG/SA            | 1 17 00262  | 10 |                                 |             |    |
| <b>Angled bracket,</b><br>for fixing DIN rails at an angle of 30° with M6 screw, height: 46 mm  | BG/SH            | 1 17 00263  | 10 |                                 |             |    |
| <b>Angled bracket,</b><br>as above, however, with a stop for the DIN rail   | BG/SHA           | 1 17 00264  | 10 |                                 |             |    |
| <b>Flat bracket,</b><br>for fixing DIN rails 12 mm above the mounting surface, with M6<br>screw   |                  |             |    | BG/F                            | 1 17 00265  | 10 |
| <b>Flat bracket,</b><br>for fixing DIN rails 15 mm above the mounting surface,<br>fixing hole 6.5 mm ø  |                  |             |    | BG/F1                           | 1 17 00266  | 10 |
| <b>Support</b><br>for fixing DIN rails 21 mm above the mounting surface, with M6<br>screw, countersunk fixing hole 6.1 mm ø. can also be used for<br>protective insulation of terminal strips |                  |             |    | AB/NS                           | 1 17 00267  | 10 |
| <b>Material</b><br>Inflammability class in acc. with UL 94  | Steel            |             |    | Steel / (AB/NS : PA)<br>-/ (V2) |             |    |
| <b>Color</b>  | Yellow chromated |             |    | Yellow chromated / (gray)       |             |    |

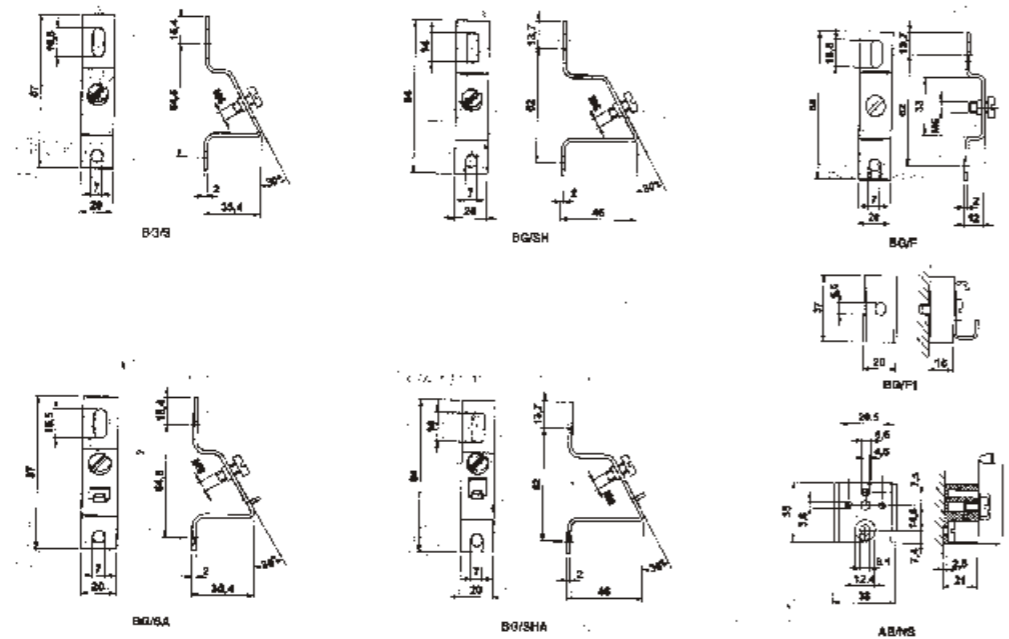

## Profile Cutters, PC

The PC profile cutter can be used to cut the most common EN mounting rails TDR2 & TDR3 series as well as neutral busbars NLS-CU 3/10 practically without blur and in a flash.



Profile Cutter, PC

| Description   | Type             | Article No. |   |
|---|------------------|-------------|---|
| <b>Profile Cutter,</b><br>without stamping tool, accepts 2 interchangeable stamping bits,<br>however, with inch/ millimeter measuring bar | PC Series 1-11/M | 1 17 00269  | 1 |